

IVECO

E5

STRALIS

ACTIVE SPACE³

AS440S45TF/P-LT

4x2 Tractor

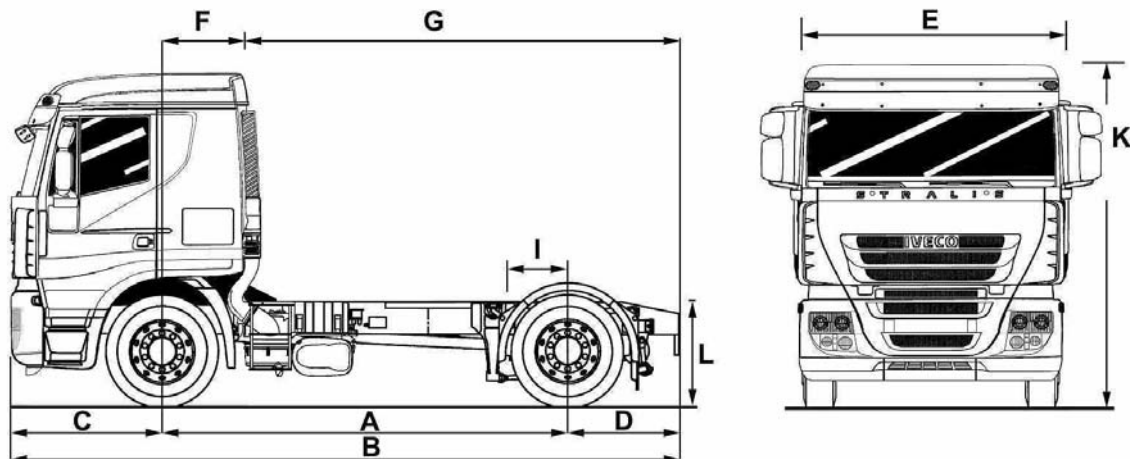

PLATED/DESIGN WEIGHTS (kg)	GVW	GTW	Front Axle	Rear Axle
Plated weights	18000	40000	7100	11500
Design weights	19000	44000	8000	13000
KERBWEIGHTS (kg) – WHEELBASE	3650			
Front	4800			
Rear	2225			
Total	7025			
TRAILER/ PAYLOAD @ 40000 (kg) GTW	32975			
DIMENSIONS (mm)				
A Wheelbase	3650			
B Overall length (over bumpers)	6108			
C Front overhang	1410			
D Rear overhang	1048			
E Cab width (over front bumper)	2550			
F C/line f/axle to back of cab equip	940			
G Back of cab to end of frame	3758			
I Fifth wheel position	Maximum 590			
(Assuming 13.6m trailer)	Minimum 530			
K Cab height (unladen r.o.f.)	3180			
L Frame height	842			
Fifth wheel face height (unladen)	982			
Fifth wheel face height (laden)	960			
Frame thickness	6.7			
Turning circle (wall to wall)	14580			
TYRES & WHEELS	Tyre Size	Tread	Wheels	
	Front	Rear	Front	Rear
Standard	315/60R22.5	295/60R22.5	On Road	Traction
Optional	315/60R22.5	315/60R22.5	On Road	Traction
			Front	Rear
			22.5x9.00	22.5x9.00
			22.5x9.00	22.5x9.00

NOTES

Weights are to standard specification and include water, oils, 5 litres of AdBlue and 20 litres of fuel but excludes driver.

Kerb weights are subject to a manufacturing tolerance of +/-5%.

February 2008

IVECO

STRALIS

ACTIVE SPACE 3

AS440S45TF/P-LT

ES

4x2 Tractor

ENGINE	Iveco Cursor 10
Cylinders	6
Bore (mm)	125
Stroke (mm)	140
Capacity (litres)	10.3
Power (PS/kW)	450/331
@ rpm	1550-2100
Torque (Nm/lbft)	2100/1549
@ rpm	1050-1550
Green Zone @ rpm	1100-1500
Rating	Euro 5
Cooling Fan	3 speed electro- magnetic
Fuel System	Unit Injector System
Turbocharger	Variable geometry
Exhaust	SCR catalyst system
Speed Limiter	Standard 90 Kilometer/hr @ 1402 rpm
Engine Immobiliser	Standard

GEARBOXES	Eurotronic AS2330 TD
1 st	15.86
2 nd	12.33
3 rd	9.57
4 th	7.44
5 th	5.87
6 th	4.57
7 th	3.47
8 th	2.70
9 th	2.10
10 th	1.63
11 th	1.29
12 th	1.00

Rev 1	14.68
Rev 2	11.41

PERFORMANCE

– with Eurotronic AS2330 TD gearbox and standard tyres

Axle ratios available	2.64	2.85
Geared speed (mph)	82	76
Gradeability (% @ 4000kg GTW)	40+	40+

CLUTCH

Type	Single plate, diaphragm spring, pull type. Asbestos free
Diameter / Friction area	432 mm / 994 cm ²

BRAKES

Type	Electronic braking system (EBS)
Front	436mm ventilated disc
Rear	436mm ventilated disc
Park brake	Actuates spring brake chambers on front axle and drive axle
Iveco turbo brake (de-compression engine brake)	Standard
Heated air drier	Standard
Air reservoirs	Aluminium
ABS	Standard
ASR Traction Control	Standard

CHASSIS

Type	Ladder construction with pressed steel side members and riveted and bolted cross members. Catwalk and step, trailer air (C couplings) and electrical connections, 5 th wheel mounting plates, trailer coupling lamp.
------	---

FUEL TANK

Type	570 litres, aluminium Locking fuel cap
------	---

AdBlue Tank

Type	55 litres, plastic, heated.
------	-----------------------------

ELECTRICS

Type	24v negative earth return
Alternator	28v, 90A
Starter	24v, 5.5kW
Battery	2 x 12v, 220Ah
Isolation switch	Electronically controlled All circuits protected by fuses Multiplex 4 CAN line data bus system

SUSPENSION

Front	Parabolic + pneumatic
Rear	Pneumatic (ECAS)
Anti-roll bar	Front and rear
Shock Absorbers	Front and rear

STEERING

Type	Power assisted
Ratio	22.2:1 - 26.2:1

AXLES

Front	Iveco 5876 I-beam with oil filled hubs
Rear	Meritor MS13-175 Hypoid
Diff Lock	Standard
Standard Ratios	Eurotronic AS2330TD gearbox 2.64:1

CAB INTERIOR

Active Space Cab: Interior incorporating. Heated air suspended 3-way adjustable driver's seat with pneumatic adjustable lumbar support, and inertia reel belt. Soft feel dashboard and multi-functional steering wheel incorporating touch button menu controls for the real time digital display. Satin silver finish instrument dial surrounds, dash and central console inlays. Dual scale speedometer. All gauge functions monitored using international symbols. Heater with 4-speed fan for airflow up to 600m³/hr, 12kW output. Air conditioning. Eberspacher night heater. Slide out fridge. Left and right hand entry assist handles. Adjustable steering column, 2 column mounted control stalks, left stalk operating the indicators, main beam, windscreen wash wipe, right stalk operating Eurotronic 2 gear change, engine brake, cruise control and variable speed limiter. Left of the steering column is the console mounted Eurotronic gearbox controls for automatic and semi-automatic modes, neutral, reverse and low speed manoeuvring mode (forward and reverse). Overhead console for CB radio. Automatic electronic 2-man tachograph. Remote control radio/CD, aerial and speakers. Two corner spot lamps illuminating cab access. Two centrally mounted spot lamps, side courtesy / night time driving lights, one map reading light. Cellular phone preparation. Vehicle data interface (FMS). Electrically operated roof vent. Standard three piece lower bunk incorporating a seating area, comfort seat, inertia reel belt, fold away central table, illuminated by two spot lamps. Flat floor-covering the living area of the cab. Lower bunk control panel incorporating switches for roof vent and interior lights, 12V socket and alarm clock. Electric operated windscreen blind. Door roller blinds. Curtains to enclose the entire cab area.

CAB EXTERIOR

Active Space Cab: forward control sleeper. Galvanised pressed steel construction with SMC for vulnerable parts. New design 4 bellow air suspension and dampers. Electrical Hydraulic cab tilt to 60° deg. Tinted electric door windows and laminated screen. Air horns. External sun visor. Heated and electrically controlled rear-view mirrors, plus kerb, wide-angle mirrors and front view mirror. Remote controlled central locking. Colour coded bumper. Additional head and fog lights. Head lamp jet wash Left and right hand external under cab stowage. Left and right hand upper external stowage for tools, warning triangle, and first aid kit.

The information in this literature is intended to be of a general nature only. Iveco Ltd reserves the right to modify or change specification at any time. For further information please consult your dealer.

February 2008